

JEFFERY STREET (UNASSUMED ROAD)

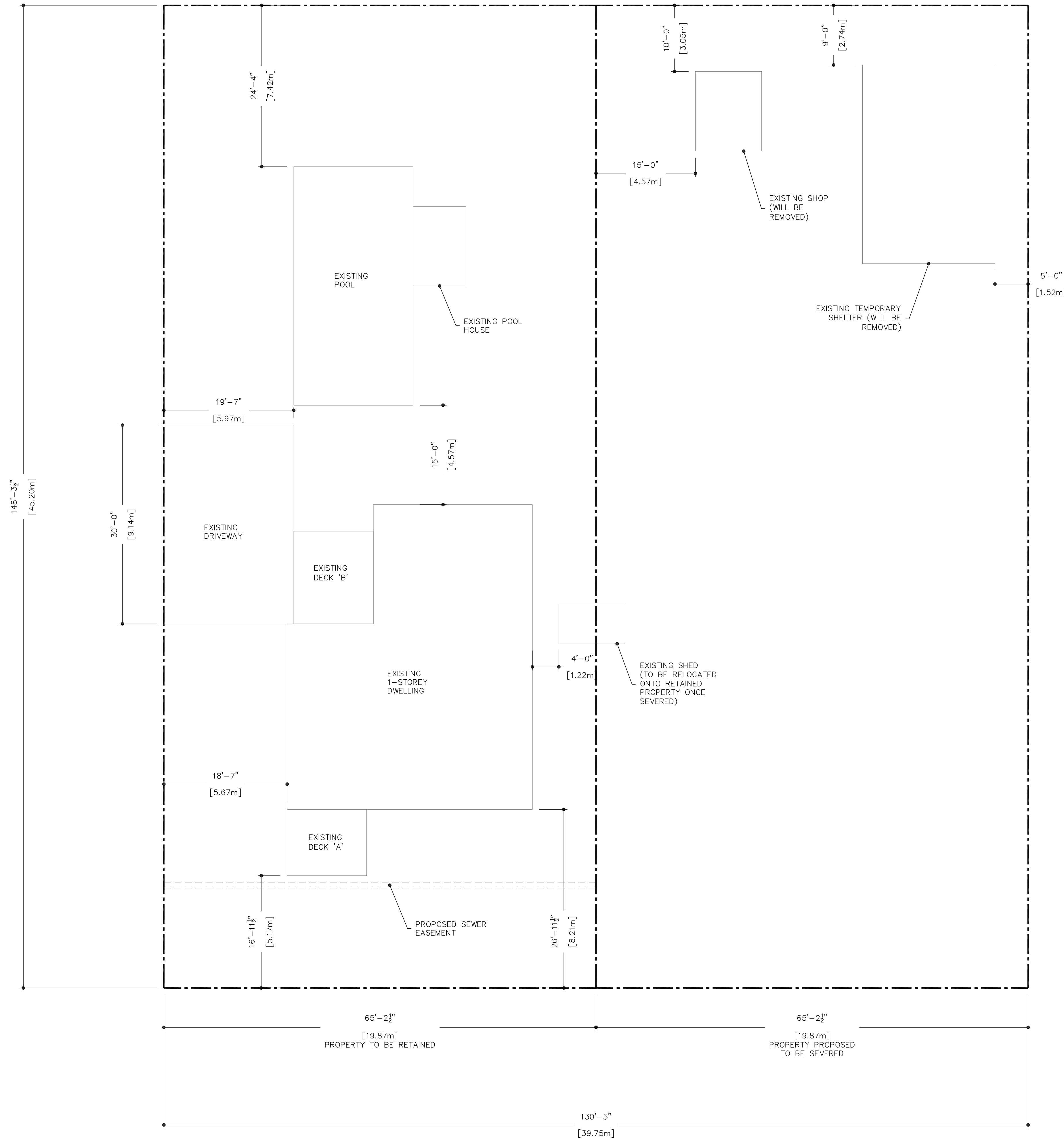

LUCY STREET

DRAWING LIST

S1.1 SITE PLAN



SITE INFO
 INFO TAKEN FROM PARTIAL SURVEY
 PART OF LOTS 6 & 7 AND 15 & 16
 CONC
 PLAN 404
 TOWN OF PENETANGUISHENE
 COUNTY OF SIMCOE

Site statistics	SF	m2
Lot area	19338.32	1796.6
Basement	0	0.0
Main floor	1468	136.4
Deck 'A'	120	11.1
Deck 'B'	168	15.6
Ground floor area (footprint)	1756	163.1
Shed (t/b relocated)	60	5.6
Pool House	96	8.9
Shop (t/b removed)	120	11.1
Temporary Shelter (t/b removed)	600	55.7
Total accessory (footprint)	876	81.4
Total ground floor area	2632	244.5
Gross floor area	2632	244.5
	Actual	
Lot Coverage	13.6%	

THE UNDERSIGNED HAS REVIEWED & TAKES RESPONSIBILITY FOR THIS DESIGN. HE HAS THE QUALIFICATIONS TO BE A DESIGNER & THE FIRM IS REGISTERED.

QUALIFICATION INFORMATION
 SEAN OUELLET _____ (22817)
 NATHAN ARCHER _____ (45195)

REGISTRATION INFORMATION
 OUELLET & ASSOCIATES DESIGN INC. (37568)

NO.	DATE	REVISION

Quellet & Associates Design Inc.
 ARCHITECTURAL DESIGN SERVICES
 1 COUNTY ROAD 6 SOUTH, TINY L0L 2J0
 (705) 245-8808 www.dodesign.ca

SHEET TITLE
SITE PLAN

PROJECT NAME
PROPOSED SEVERANCE FOR LARRY BUTSON
 -
25 LUCY ST, PENETANGUISHENE

SCALE 1:100	DRAWN BY D.F.
DATE SEP 11/24	CHECKED S.O.
PROJECT 24-251	DRAWING S1.1

